

5. Investment

Specific Tooling cost

Tooling cost amortized in piece price

Manufacturing equipment cost

6. Documents

Statement of Work Yes No TBDQuality Agreements Yes No TBDIATF16949 requested Yes No TBDPurchasing Agreements: Yes No TBD

7. General information/Description of application

Description of application

Why will a flexible connection be required here?

Is there already a solution? Yes NoNDA required? Yes No

8. Electrical data

 Direct current (DC) Alternat. current (AC)

Frequency f

Hz

Rated current I A

Rated voltage U V

Short circuit current (r.m.s. value) I_k A t_k

s

Test voltage (50Hz/1min.) U V

Rated peak current (peak value) i_p A

9. Ambient conditions

Min. ambient Temperature °C

Max. ambient Temperature °C

Air Water Aggressive atmosphere

Relative humidity %

Oil Other Vibrations Hz / g

10. Type of connector

Plug, round Rack and panel connector With locking Socket, round Rotary contact With coding Fork type, for bus bars Multi-pole Other types Flat type

Number of poles

11. Connections/Mounting

Screwed/bolted termination Crimp Other Soldering Pressfit Ultrasonic welding

12. Material and dimensions of conductor

<input type="checkbox"/> Cable	Type of wire class	<input type="checkbox"/> Busbar			
Cable designation	Material	Material			
	Cross-section	mm ²	Dimensions	mm x	mm

13. Mechanical data

Contact making part	<input type="checkbox"/> Borehole	<input type="checkbox"/> Pin	<input type="checkbox"/> Busbar		
<input type="checkbox"/> Plugging movement	Number per	Material			
Cycles <input type="checkbox"/> Sliding movement	Total				
<input type="checkbox"/> Rotary movement	Travel	mm/	m/sec	Electroplating	µm
Angle	° Number of revolutions			max. sliding force	N
max. torque	Rotary speed	rpm	Max. operating temp.		°C

14. Dimensions of borehole (mm)

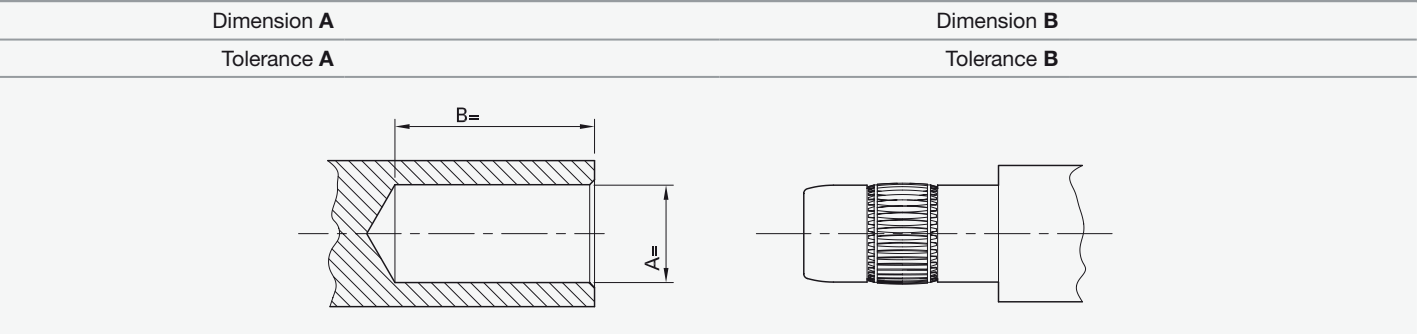

14. Dimensions of pin (mm)

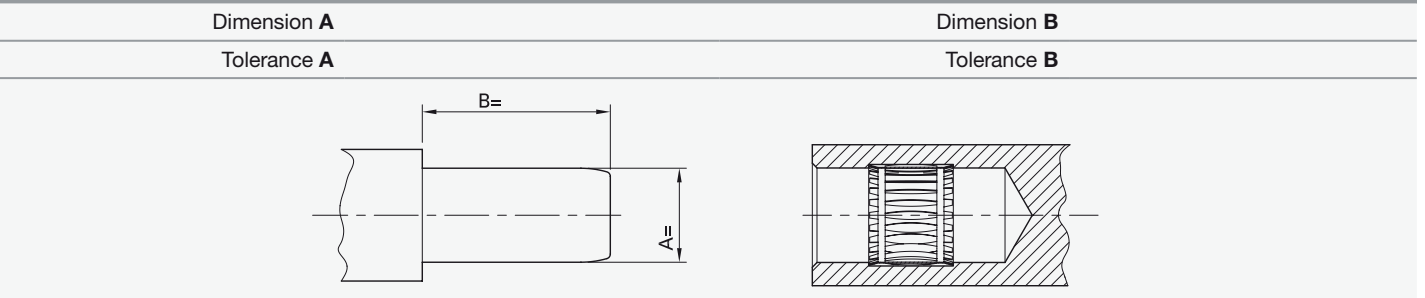

14. Dimensions of busbar (mm)

