

# SEB4-F/A

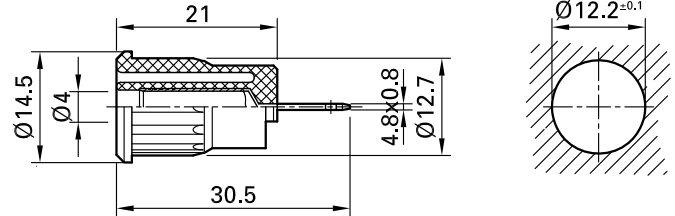

Item number 23.3160-\*

Insulated, rigid, Ø 4 mm, accepting spring-loaded Ø 4 mm plugs with rigid insulating sleeve. Brass sheet. The socket is pressed into pre-drilled panels of plastic, metal, etc. Flat connecting tab 4.8 mm x 0.8 mm, can be bent to 90°, once only.

Technical data	
Diameter of plug system	4 mm
Rated Values	1000 V, CAT III, 24 A
Surface treatment electrical contact	Ni
Base material electrical contact	CuZn
Standard color(s) *	<span style="background-color: #90EE90; border: 1px solid black; padding: 2px;">20</span> <span style="background-color: #000000; color: white; border: 1px solid black; padding: 2px;">21</span> <span style="background-color: #FF0000; color: white; border: 1px solid black; padding: 2px;">22</span> <span style="background-color: #0000FF; color: white; border: 1px solid black; padding: 2px;">23</span> <span style="background-color: #FFFF00; border: 1px solid black; padding: 2px;">24</span> <span style="background-color: #008000; color: white; border: 1px solid black; padding: 2px;">25</span> <span style="background-color: #8B4513; color: white; border: 1px solid black; padding: 2px;">27</span> <span style="background-color: #A9A9A9; border: 1px solid black; padding: 2px;">28</span> <span style="border: 1px solid black; padding: 2px;">29</span>
Test accessory acc. to	IEC EN 61010-2-030
Remarks	Accessories: Flat connecting receptacles FSH4,8x0,8; Press-in tool MB4-S
Approvals	UR