

PLAST-2V 0,25

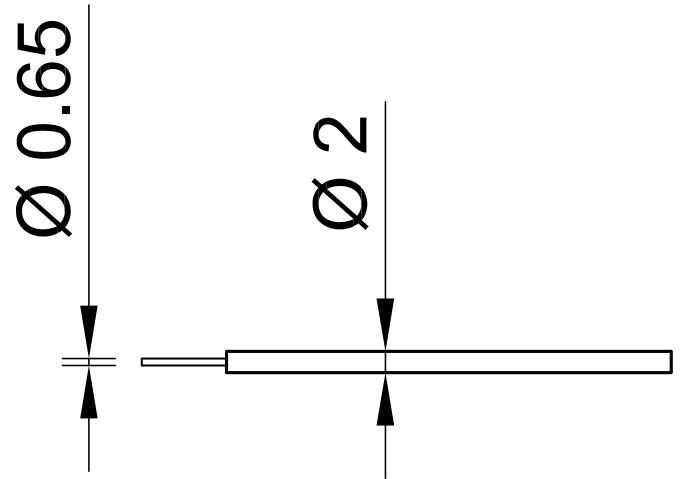

Item number 60.7240-*

Highly flexible stranded wire 0,25 mm² with reinforced, double-layer insulation for the highest safety

Technical data	
Rated Values	AC 1000 V, 6 A / DC 1500 V, 6 A
Standard color(s) *	21 22 23
Lead insulation	TPE
Temperature range	-30 °C ... +90 °C
Strand design (n x Ø mm)	66 x 0,07
Lead weight	4.9 kg/km
Conductor diameter	0.65 mm
Cable diameter	2.0 mm
Insulation thickness	0.65 mm
Approvals	CE, UKCA, EAC