

PLAST-2V 2,0

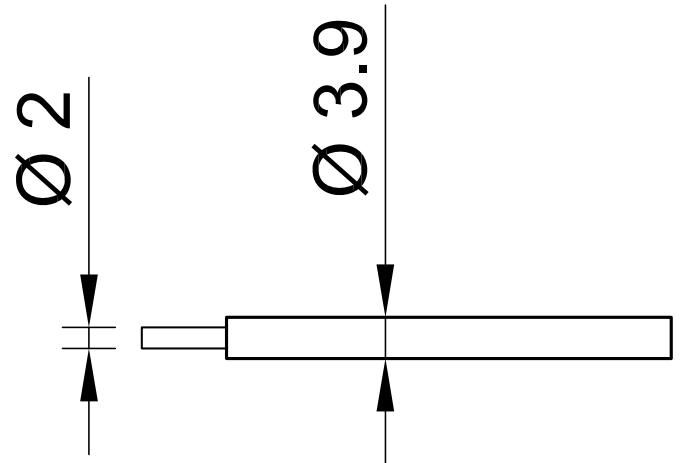

Item number 60.7265-*

Highly flexible stranded wire 2,0 mm² with reinforced, double-layer insulation for the highest safety

Technical data	
Rated Values	AC 1000 V, 30 A / DC 1500 V, 30 A
Standard color(s) *	21 22 23
Lead insulation	TPE
Temperature range	-30 °C ... +90 °C
Strand design (n x Ø mm)	525 x 0,07
Lead weight	27.0 kg/km
Conductor diameter	2.0 mm
Cable diameter	3.9 mm
Insulation thickness	0.95 mm
Approvals	CE, UKCA, EAC