

SILI-E 0,15

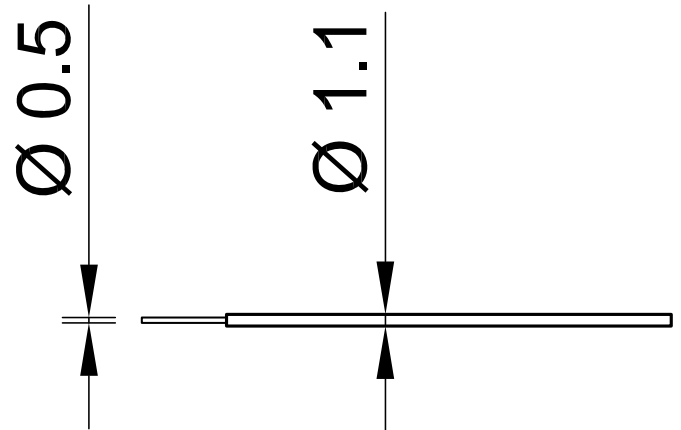
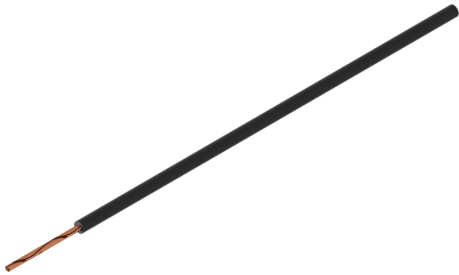

Item number 61.7550-*

Super flexible basic insulated stranded wire 0,15 mm².

Technical data	
Rated Values	AC 150 V, 6 A
Standard color(s) *	21 22 23 24 25 27 29
Lead insulation	SIL
Temperature range	-50 °C ... +90 °C
Strand design (n x Ø mm)	39 x 0,07
Lead weight	2.1 kg/km
Conductor diameter	0.5 mm
Cable diameter	1.1 mm
Insulation thickness	0.3 mm
Approvals	CE, UKCA, EAC