

# SILI-E 0,75

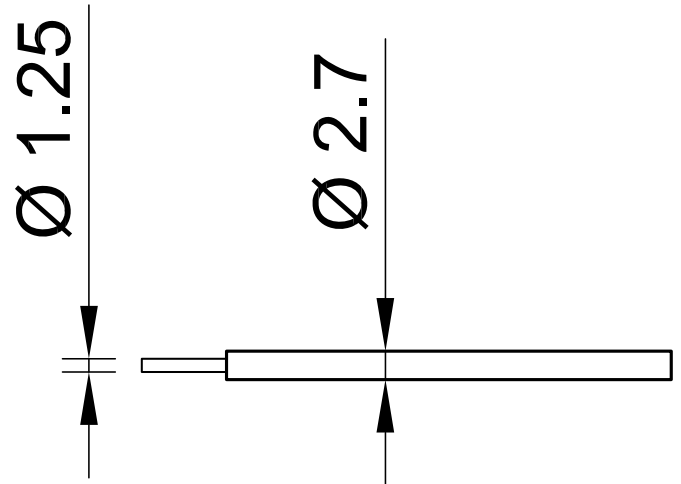

Item number 61.7553-\*

Super flexible basic insulated stranded wire 0,75 mm<sup>2</sup>.

Technical data	
Rated Values	AC 600 V, 15 A
Standard color(s) *	<span style="background-color: #90EE90; padding: 2px;">20</span> <span style="background-color: #000000; padding: 2px;">21</span> <span style="background-color: #FF0000; padding: 2px;">22</span> <span style="background-color: #0000FF; padding: 2px;">23</span> <span style="background-color: #FFFFFF; padding: 2px;">29</span>
Lead insulation	SIL
Temperature range	-50 °C ... +90 °C
Strand design (n x Ø mm)	196 x 0,07
Lead weight	12.0 kg/km
Conductor diameter	1.25 mm
Cable diameter	2.7 mm
Insulation thickness	0.7 mm
Approvals	UR, CE, UKCA, EAC