

# SILI-1V 1,0

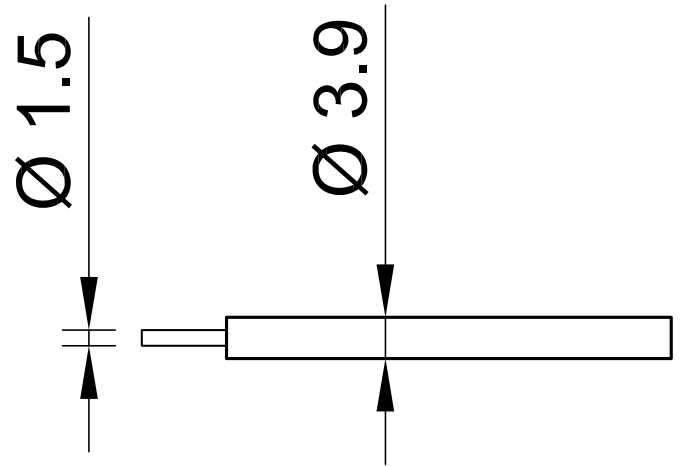

Item number 61.7607-\*

Super flexible stranded wire 1,0 mm<sup>2</sup> with reinforced insulation.

Technical data	
Rated Values	AC 1000 V, 19 A / DC 1500 V, 19 A
Standard color(s) *	<span style="background-color: #ffff00; border: 1px solid black; padding: 2px;">20</span> <span style="background-color: #000000; color: white; border: 1px solid black; padding: 2px;">21</span> <span style="background-color: #ff0000; color: white; border: 1px solid black; padding: 2px;">22</span> <span style="background-color: #0000ff; color: white; border: 1px solid black; padding: 2px;">23</span> <span style="background-color: #ffff00; border: 1px solid black; padding: 2px;">24</span> <span style="background-color: #008000; color: white; border: 1px solid black; padding: 2px;">25</span> <span style="background-color: #800080; color: white; border: 1px solid black; padding: 2px;">26</span> <span style="background-color: #ffffff; border: 1px solid black; padding: 2px;">29</span>
Lead insulation	SIL
Temperature range	-50 °C ... +90 °C
Strand design (n x Ø mm)	511 x 0,05
Lead weighth	21.0 kg/km
Conductor diameter	1.5 mm
Cable diameter	3.9 mm
Insulation thickness	1.2 mm
Approvals	UR, CE, UKCA, EAC