

SILI-2V 1,0

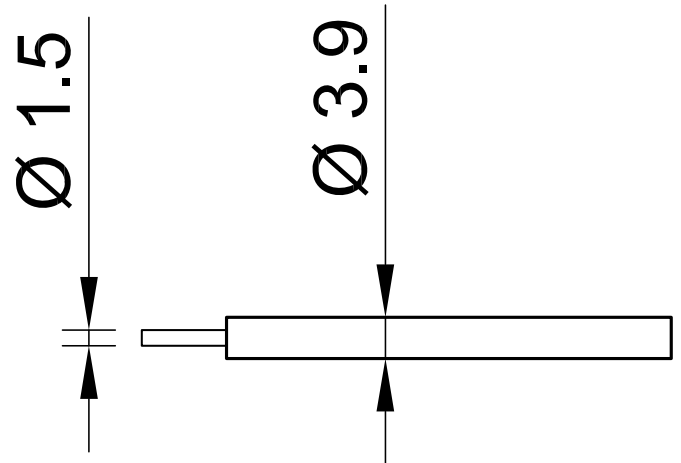

Item number 61.7664-*

Super flexible stranded wire 1,0 mm² with reinforced, double-layer insulation for the highest safety.

Technical data	
Rated Values	AC 1000 V, 19 A / DC 1500 V, 19 A
Standard color(s) *	21 22 23 25
Lead insulation	SIL
Temperature range	-50 °C ... +90 °C
Strand design (n x Ø mm)	511 x 0,05
Lead weight	21.0 kg/km
Conductor diameter	1.5 mm
Cable diameter	3.9 mm
Insulation thickness	1.2 mm
Approvals	UR, CE, UKCA, EAC